

## Gas Discharge Tube – PG35E-M Series

### Features

- DC Spark-over voltage: 75~1100V
- Low Capacitance
- Micro-Gap Design
- Stable breakdown voltage
- RoHS & HF compliant
- High holdover voltage
- High insulation resistance
- Large absorbing transient current capability.

### Applications

- Communication equipment
- Test equipment
- Data lines
- CATV equipment
- Power Supplies
- Telecom SLIC protection
- Telecommunications

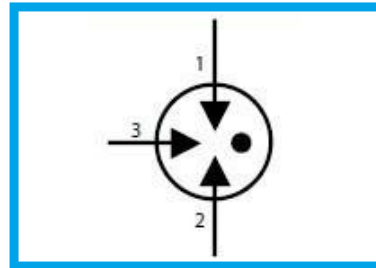

### General Characteristics Definition

- Operating temperature: -40 ~ 85°C
- Storage temperature: -40 ~ 85°C

### Part Number Code

PG □ □ □ □ □ □ □ □ □ □

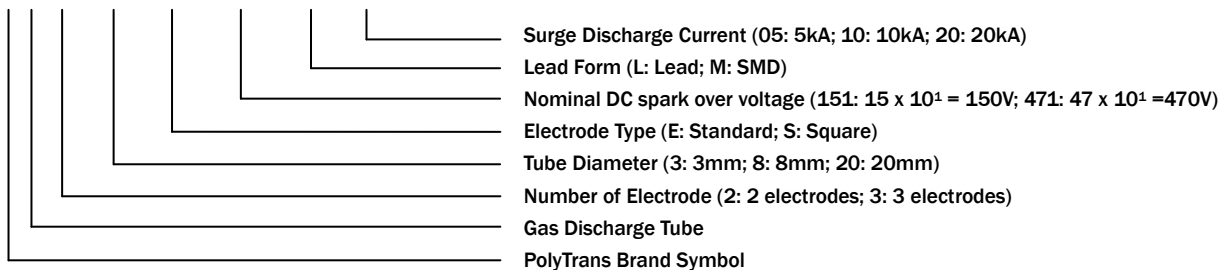

### Physical Dimensions

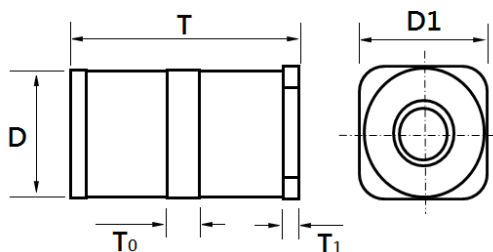

Symbol	Dimension (mm)
D	5.0±0.5
D <sub>1</sub>	5.0±0.5
T	7.6±0.5
T <sub>0</sub>	1.50±0.2
T <sub>1</sub>	0.40±0.1

### Solder pad layout

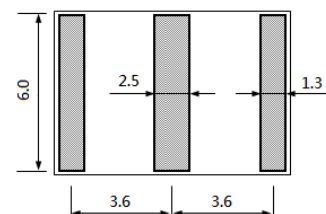

## Gas Discharge Tube – PG35E-M Series

### Electrical Characteristics

Part Number	DC Spark-over Voltage @ 100V/S (V)	Impulse Spark-over Voltage @ 1kV/ $\mu$ S (V)	Impulse Discharge Current (8/20 $\mu$ S)		AC Discharge Current	Minimum Insulation Resistance (G $\Omega$ )	Maximum Capacitance @ 1.0 MHz (pF)	UL Certificate (E474915)
			1 Hits	10 Hits	1 sec/50 Hz			
			(kA)	(kA)	(A)			
PG35E075M05	75 $\pm$ 20%	$\leq$ 700	10	5	5	1	2.0	✓
PG35E091M05	90 $\pm$ 20%	$\leq$ 600	10	5	5	1	2.0	✓
PG35E121M05	120 $\pm$ 20%	$\leq$ 600	10	5	5	1	2.0	-
PG35E151M05	150 $\pm$ 20%	$\leq$ 600	10	5	5	1	2.0	✓
PG35E201M05	200 $\pm$ 20%	$\leq$ 700	10	5	5	1	2.0	✓
PG35E231M05	230 $\pm$ 20%	$\leq$ 700	10	5	5	1	2.0	✓
PG35E251M05	250 $\pm$ 20%	$\leq$ 700	10	5	5	1	2.0	✓
PG35E351M05	350 $\pm$ 20%	$\leq$ 750	10	5	5	1	2.0	✓
PG35E401M05	400 $\pm$ 20%	$\leq$ 800	10	5	5	1	2.0	✓
PG35E421M05	420 $\pm$ 20%	$\leq$ 800	10	5	5	1	2.0	✓
PG35E471M05	470 $\pm$ 20%	$\leq$ 900	10	5	5	1	2.0	✓
PG35E601M05	600 $\pm$ 20%	$\leq$ 1000	10	5	5	1	2.0	✓
PG35E801M05	800 $\pm$ 20%	$\leq$ 1400	10	5	5	1	2.0	-
PG35E112M05	1100 $\pm$ 20%	$\leq$ 1750	10	5	5	1	2.0	-

### Marking Definitions

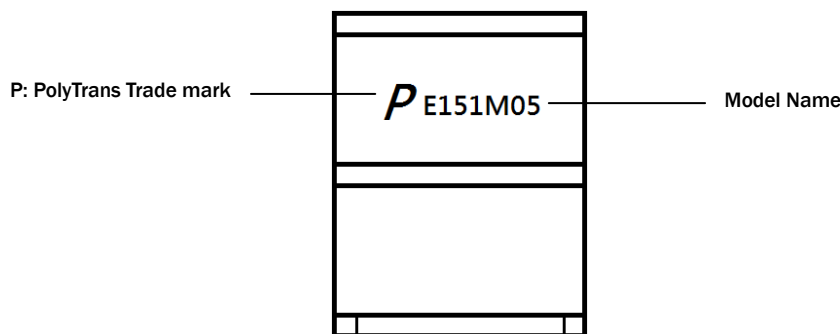

### Lead Free Reflow Soldering Recommendations

<b>Preheat</b>	
- Temperature Min (T <sub>smin</sub> )	150°C
- Temperature Max (T <sub>smax</sub> )	200°C
- Time (T <sub>smin</sub> to T <sub>smax</sub> )	60-180 seconds
- Average Ramp-Up Rate	1~3°C/second
<b>Peak Temperature</b>	260°C max.
<b>Time within 5°C of actual Peak Temperature (t<sub>p</sub>)</b>	40 seconds max.
<b>Ramp-Down Rate</b>	6 °C /second max.

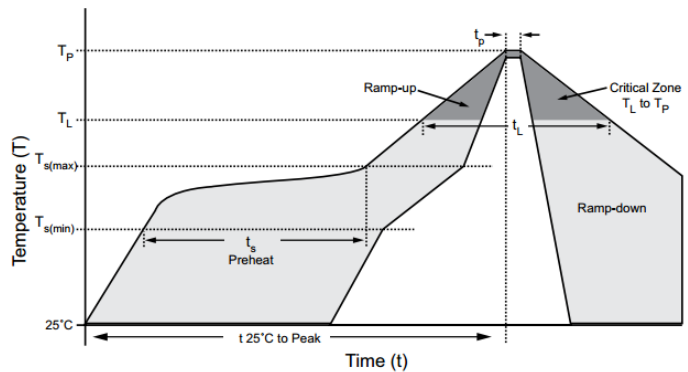

Note: If the reflow soldering temperatures exceed the recommended profile, devices may not meet the performance requirements.

## Gas Discharge Tube – PG35E-M Series

### Packaging Information

Part Number	Quantity (EA/Roll)
PG35E-M Series	1000

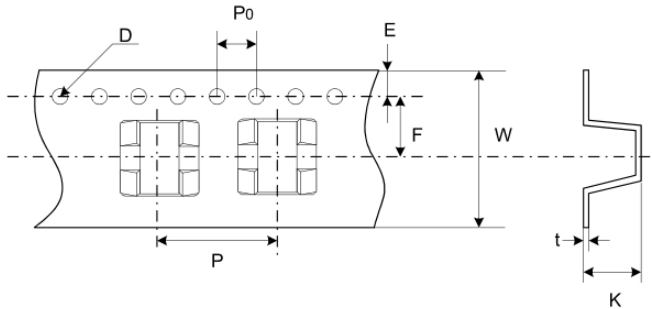

Dimension	Millimeters
P	12.0±0.1
P0	4.0±0.1
D	1.55±0.05
E	1.75±0.1
F	7.5±0.1
W	16.0±0.3
T	0.50±0.05
K	5.5±0.1